

NEW WHEEL BEARINGS - MODEL M-50

Starting with M-50 motorcycle Serial No. 65M-7500, wheel hubs have been redesigned to incorporate retainer-type ball bearings which replace the loose ball cone-type bearings used on earlier motorcycles. The two types of front and rear wheel hubs and related parts are shown in the following illustrations with parts lists for the new assemblies.

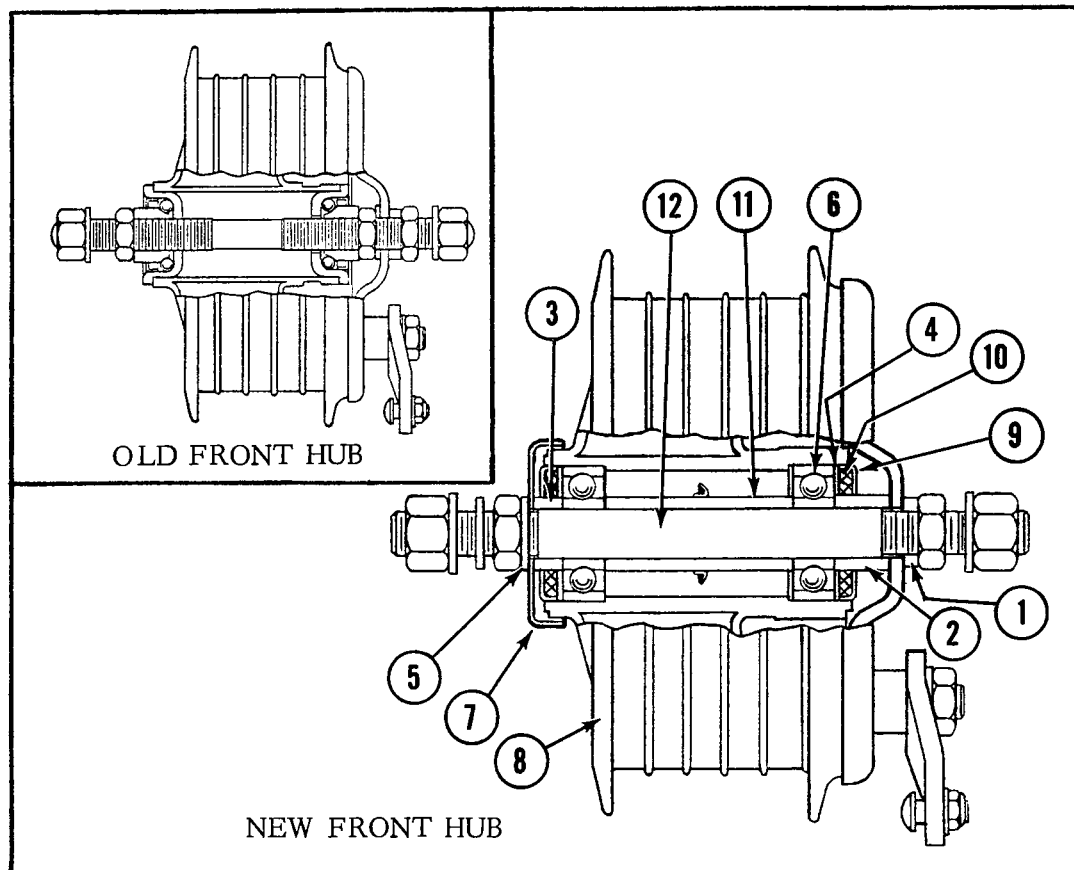

1. 5950P — SPACER, side plate outer
2. 5953P — SPACER, side plate inner
3. 5954P — SPACER, left side
4. 6017P — SEAL WASHER (2)
5. 6018P — WASHER, left side
6. 9001P — BALL BEARING (2)
7. 40510-65P — DUST SHIELD
8. 43541-65P — HUB, front wheel
9. 43722-65P — RETAINER, felt seal (2)
10. 43731-65P — FELT SEAL (2)
11. 43744-65P — SPACER, axle
12. 43877-65P — AXLE, front wheel

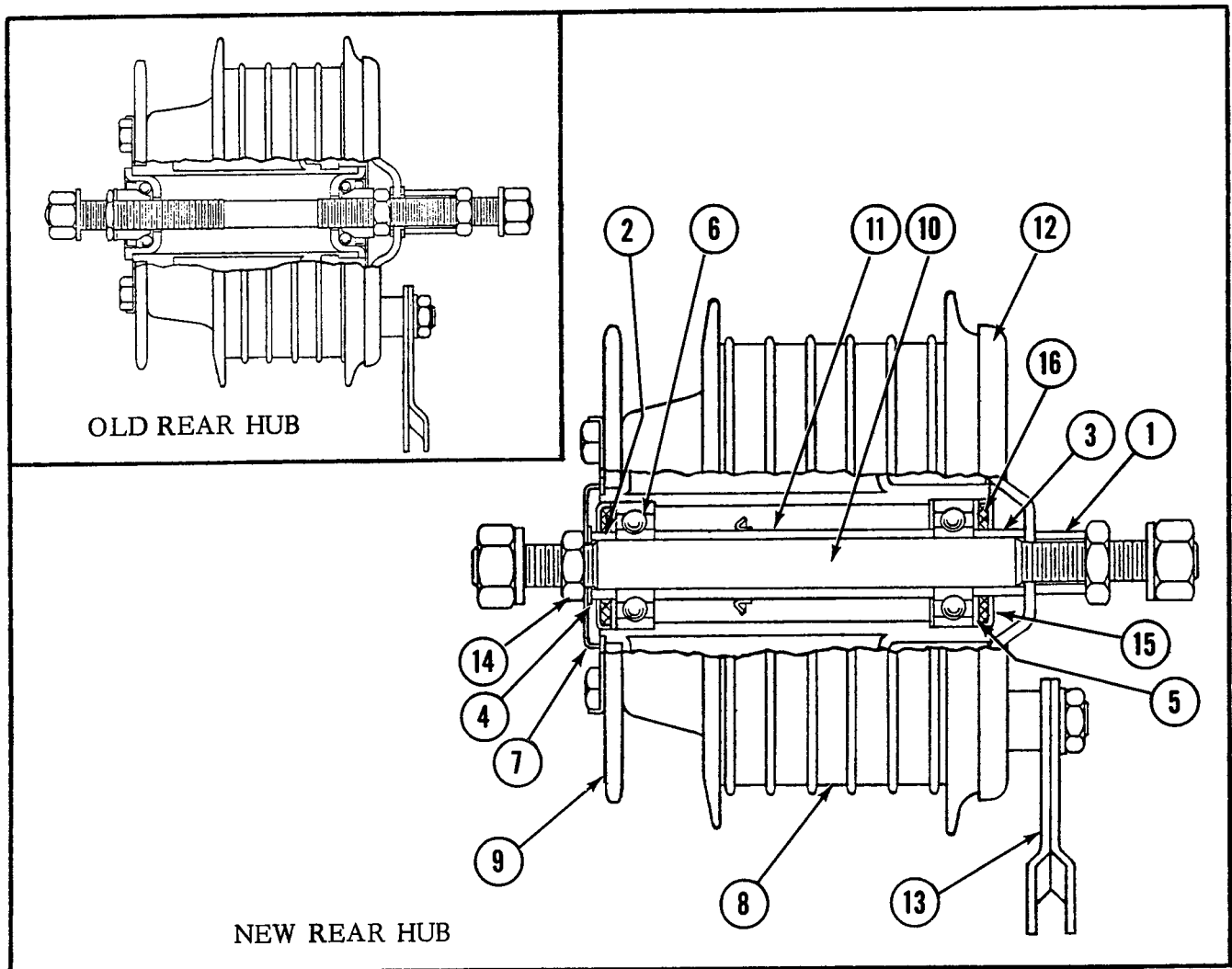

1. 5951P — SPACER, side plate outer
2. 5952P — SPACER, left bearing
3. 5953P — SPACER, side plate inner
4. 6016P — WASHER, left side
5. 6017P — SEAL WASHER (2)
6. 9001P — BALL BEARING (2)
7. 40500-65P — DUST SHIELD
8. 41021-65P — HUB, rear wheel
9. 41483-65P — SPROCKET, rear wheel
10. 41550-65P — AXLE, rear wheel
11. 41624-65P — SPACER, axle
12. 41651-65P — SIDE PLATE, brake
13. 41924-65P — LEVER, rear brake
14. 43559-65P — NUT, left side
15. 43722-65P — RETAINER, felt seal (2)
16. 43731-65P — FELT SEAL (2)

40994-65P — REAR WHEEL
ASSEMBLY