



Figure 1. Digital Technician II

Mainshaft Replacement

See Figure 2. The mainshaft replacement kit consists of the mainshaft assembly, guide hub, retaining ring and inner bearing race. All parts are model year 2010 or later and replace earlier model mainshafts as a complete kit. Refer to Table 2 for part numbers.

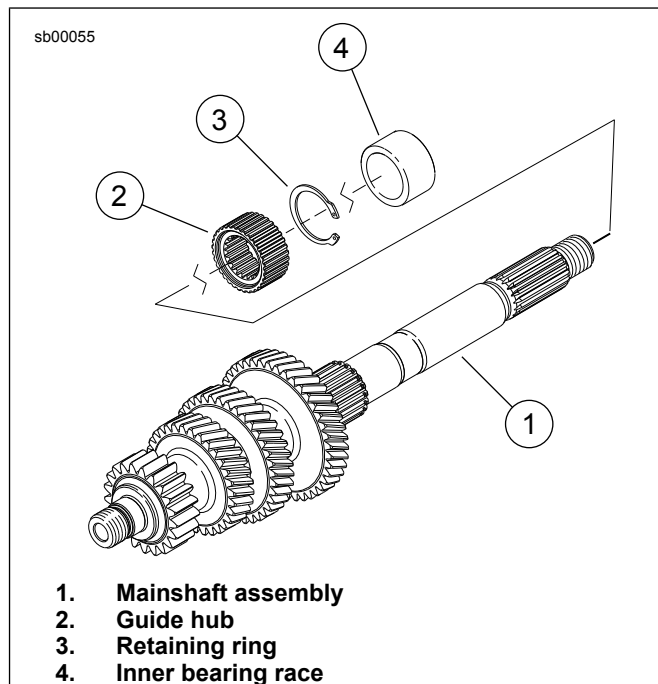

Figure 2. Mainshaft Assembly Kit

Table 2. Mainshaft Replacement Kit Part Numbers

MODEL	ALL FINISHES
2006 Dyna and all 2007-2009 Twin Cam models	35467-06C

Gear Pack Replacement

See Figure 3. The gear pack will be shipped with all the parts assembled to the side bearing housing including the shift drum, shifter fork shafts and forks. Refer to Table 3 for part numbers.

NOTE

A **new** inner primary race (Part No. 34091-08) must also be installed.

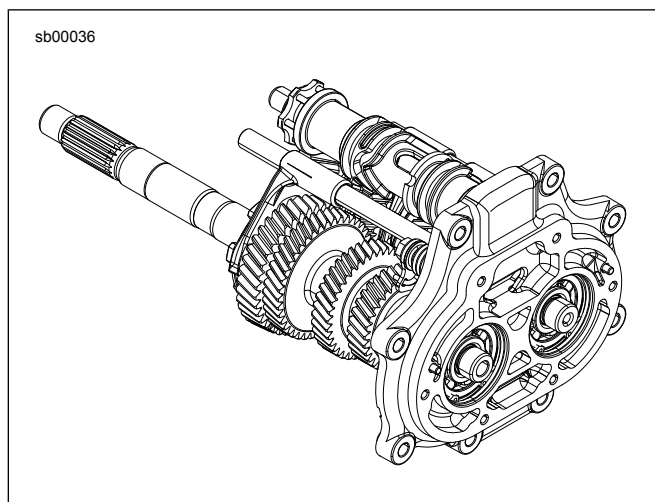

Figure 3. Gear Pack Assembly

Table 3. Gear Pack Replacement Part Numbers

MODEL	BLACK		SILVER		GRANITE	
	OLD	NEW	OLD	NEW	OLD	NEW
2006 Dyna and all 2007-2009 Twin Cam models ⁽¹⁾	35246-08A	35246-10B	35247-08A	35247-10B	35255-08A	35255-10B

(1) Installation requires the inner primary bearing race (Part No. 34091-08).

Replacement Case

See Figure 4. The replacement case is provided with all bearings, the final drive gear, the pulley, nut and lockplate installed. Refer to Table 4 for part numbers.

Case replacement will require that the following parts be removed and reused:

- Clutch cable
- Clutch release cover
- Top cover
- Gear pack, shift drum, shafts and forks
- Shifter mechanism
- Bracket
- Neutral indicator sensor
- Vehicle speed sensor (VSS)
- Engine and transmission dipsticks
- Oil pan

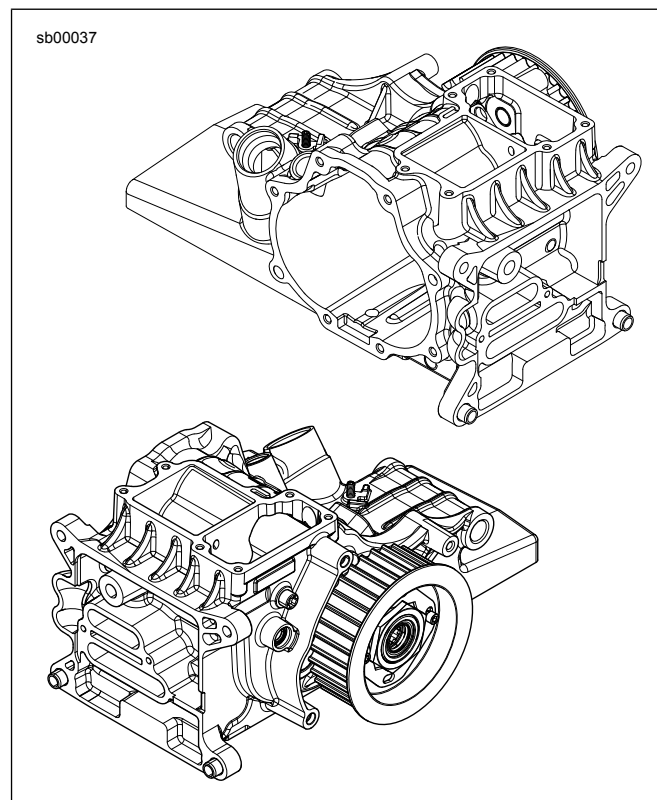

Figure 4. Transmission Case (Touring Shown)

Table 4. Case Replacement Part Numbers

MODEL		BLACK	SILVER	GRANITE
2006-2009 Dyna ⁽¹⁾		34747-06C	34746-06C	34700021
2007-2009 Softail		34799-07	34801-07	-
FXSTSSE	2007	-	34801-07	-
	2008	-	-	34857-08
	2009	-	-	34888-09
2008-2009 FXCW/C		34854-08	34855-08	-
2007-2009 Touring		34719-07B	34805-07	34853-08
2009 Trike		83978-09	-	-
(1) 2006 Dyna Models require a spacer (Part No. 11840) and a bolt (Part No. 2887WA) to mount the muffler bracket.				