

SERVICE BULLETIN



M-1375

August 24, 2014

2015 ROAD GLIDE HANDLEBAR ADJUSTMENT AT PDI

Purpose

This bulletin is to inform dealers that an additional procedure is needed during PDI on certain 2015 Road Glide models. To help provide a great initial experience for potential customers, the handlebars on all 2015 Road Glide models are to be adjusted fully forward.

Motorcycles Affected

This information applies to all 2015 FLTRX, FLTRXS and FLTRUSE models built before August 12, 2014. All models built after August 12, 2014 will have the handlebar adjusted during assembly. At the time of delivery, the handlebars can be adjusted to the riders preference, within the limits of the adjustment range.

Markets Affected

All markets are affected.

Required Dealer Action

1. Remove the main fuse.
2. Remove instrument bezel:
 - a. **FLTRX, FLTRXS:** Remove ignition switch knob. See the service manual.
 - b. See Figure 1. Lift the rear of the ignition switch cover (3). Remove cover.
 - c. Remove screws (1) on each side of instrument bezel.
 - d. Lift instrument bezel (2) to remove.
 - e. Disconnect instrument connector. Disconnect accessory switch connectors. Remove bezel assembly.
3. Loosen rear screws on the upper handlebar clamp.

NOTE

The handlebars on 2015 Road Glide models have limit pins incorporated into the handlebar mount.

4. Position handlebars as far forward as limit pins will allow.
5. Snug upper handlebar clamp screws.

6. Tighten the upper handlebar clamp screws to 16-20 ft-lbs (21.7-27.1 Nm).
7. Install instrument bezel:
 - a. Connect accessory switch connectors.
 - b. Connect instrument connector.
 - c. Lower instrument bezel assembly (2) into place. Engage pins on rear of the bezel into holes in nacelle.
 - d. Install screws (1) on each side of bezel. Tighten to 10-15 **in-lbs** (1.1-1.7 Nm).
 - e. Engage tabs of switch cover (3). Press down on rear to secure.
 - f. **FLTRX, FLTRXS:** Install ignition switch knob. See the service manual.
8. Install the main fuse.

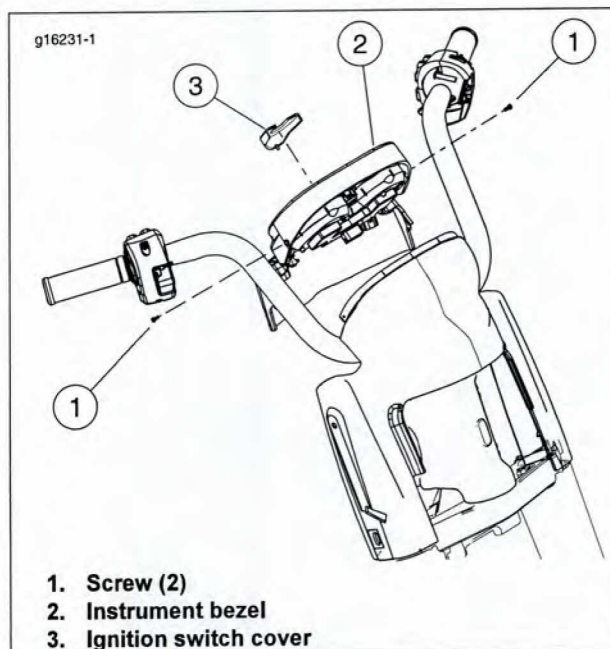

Figure 1. Instrument Bezel

NOTE

In the interest of preserving customer safety and satisfaction, always check for outstanding recalls whenever any motorcycle is brought into your dealership for either maintenance or service.

ROUTING	SERVICE MANAGER	SALES MANAGER	PARTS MANAGER	WARRANTY PROCESS MANAGER	LEAD TECHNICIAN	TECHNICIAN NO. 1	TECHNICIAN NO. 2	TECHNICIAN NO. 3	RETURN THIS TO
INITIAL-HERE									

© 2014 H-D

SERVICE BULLETIN



M-1377

August 19, 2014

TRIKE LUG NUT TORQUE

Purpose

The purpose of this service bulletin is to remind dealership service personnel of the importance of following the recommended service procedure for Trike lug nuts.

- At regular service intervals
- Any time a rear wheel is removed

Motorcycles Affected

This information affects all 2009 and later Trike models.

Markets Affected

All markets where Trikes are sold are affected.

Required Dealer Action

As a reminder, the following information is provided in the service manual regarding Trike rear wheels.

- Check the rear wheel lug nut torque at 1,000 mi (1,600 km), 10,000 mi (16,000 km) and every 10,000 mi (16,000 km) thereafter.
- Check the rear wheel lug nut torque annually or at specified intervals, whichever comes first.
- To check the torque, attempt to turn the lug nut using a torque wrench set to the minimum torque specification for that fastener. If the lug nut does not rotate, the torque has been maintained. No further attention is necessary. If the lug nut rotates, tighten to specification.
- Always check lug nut torque within 500-1000 mi (805-1610 km) after wheel installation.

NOTES

- *Recommended best practice: enter a note at the bottom of the work order reminding customer to bring vehicle in to have wheel lug nut torque rechecked. This is a great incentive for the customer to return to your dealership.*
- *Do not use an air impact wrench to install and tighten wheel lug nuts. Use only a torque wrench to achieve final specified torque.*

NOTE

In the interest of preserving customer safety and satisfaction, always check for outstanding recalls whenever any motorcycle is brought into your dealership for either maintenance or service.

ROUTING	SERVICE MANAGER	SALES MANAGER	PARTS MANAGER	WARRANTY PROCESS MANAGER	LEAD TECHNICIAN	TECHNICIAN NO. 1	TECHNICIAN NO. 2	TECHNICIAN NO. 3	RETURN THIS TO
INITIAL HERE									

© 2014 H-D