

**Figure 2. Correct Procedure**

### Improperly Installed Button

#### NOTE

*Improperly installed lock button with tabs misaligned, tabs not properly engaged or upper clutch cable interfering with the lock button, is a sign of incorrect internal adjustment. See the service manual for clutch adjustment.*

1. See Figure 3. Lock button tabs are not fully engaged (1) because the end of the upper clutch cable (2) is interfering with securing the button.
2. See Figure 4. The tabs on lock button tabs are not fully secured.
  - a. Lock button tabs partially engaged (1).
  - b. Lock button tab not fully engaged (2).
3. See Figure 5. A misaligned lock button (1, 3) is a sign of an incorrect installation.

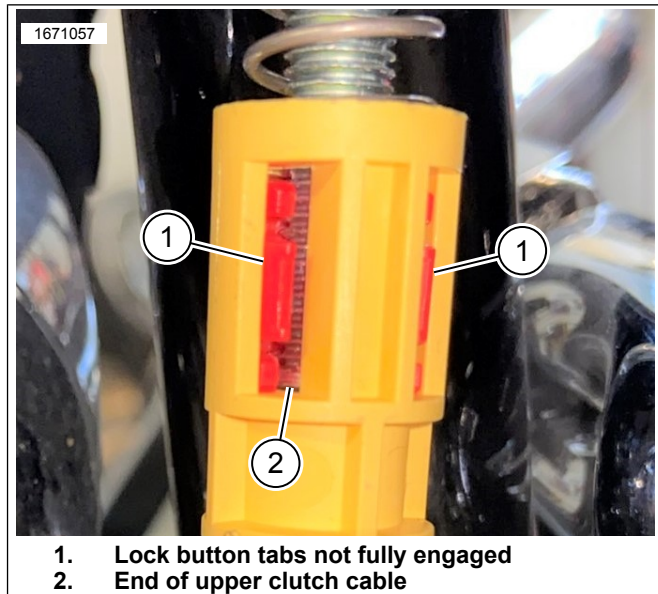

**Figure 3. Improperly Installed Button**

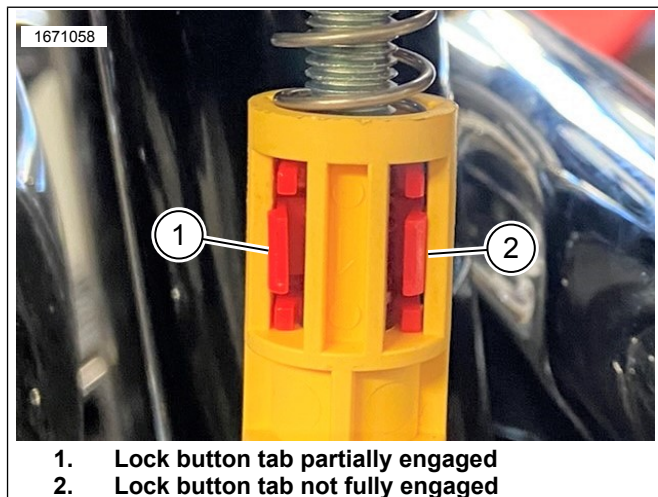

**Figure 4. Improperly Installed Button**

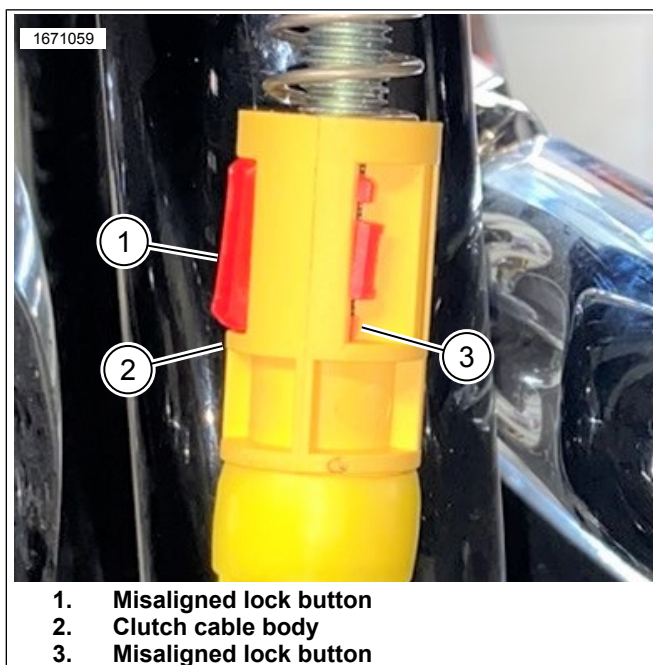

**Figure 5. Improperly Installed Button**

### Proper Button Engagement

1. See Figure 6. Lock button tabs are fully engaged (2) to clutch cable body (1).
2. See Figure 7. A properly aligned lock button (1) should be semi-flush with the rest of the cable clutch assembly.
3. The lock button tabs should be fully engaged (2) to the body.
4. See Figure 8. Make sure the lock button (4) is installed between the ends of upper clutch cable (1, 3).

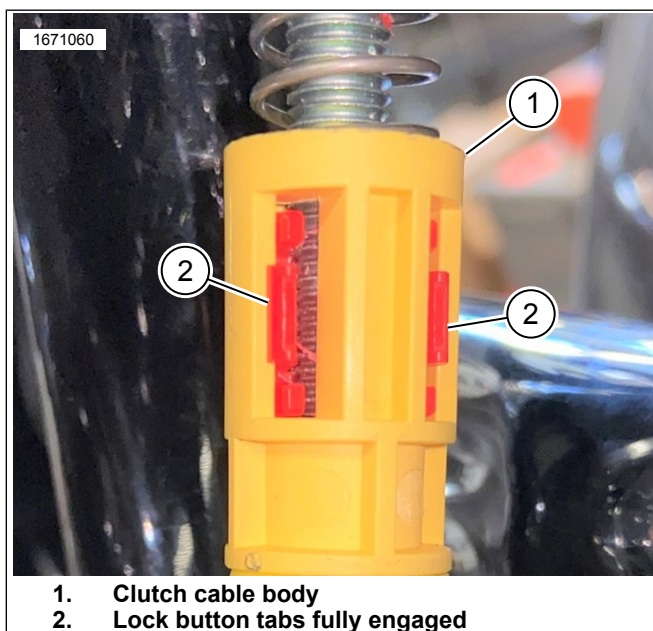

**Figure 6. Correctly Installed Button**

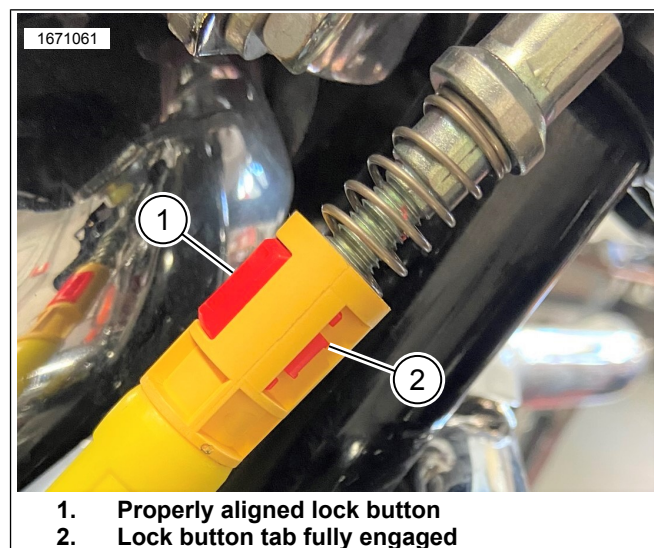

**Figure 7. Correctly Installed Button**

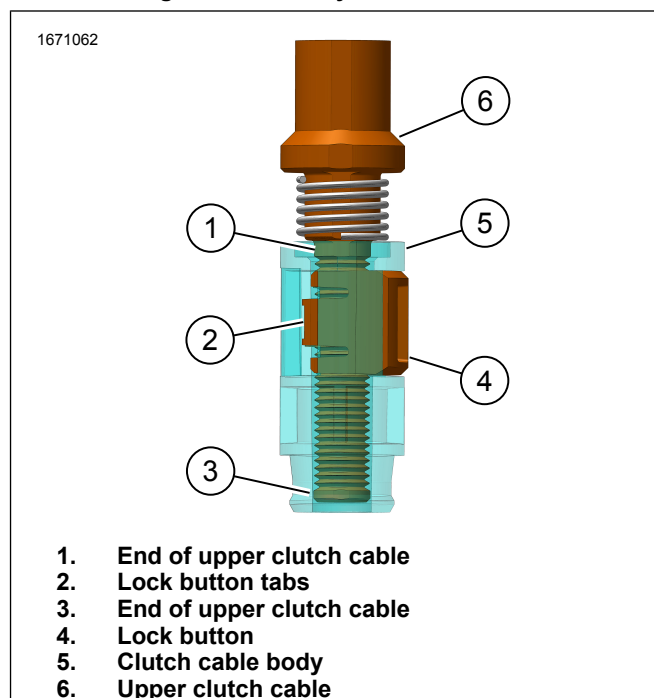

**Figure 8. Proper Button Engagement**