



INSTRUCTIONS

-J00748

REV. 1-17-97

Kit Numbers 51660-97

DETACHABLE PASSENGER SEAT HARDWARE KIT

General

This kit provides the hardware to make your passenger seat removable without tools. This kit is designed for 1997 and later XLH 1200 models.

See Service Parts illustration for kit contents.

Installation

1. Remove the rider seat and passenger seat assembly. Remove the grab strap and discard the grab strap screw, but save the washer.
2. Remove the screws that hold the rider seat and passenger seat together.
3. See Service Parts illustration. Attach seat bracket (3) to bottom of rider seat with screws (5) provided in kit.
4. Place the rider seat on frame and slide it forward so front bracket engages tab on frame. Secure rider seat and grab strap to frame with screw (6) from kit and original washer saved from step 1.

⚠WARNING

After installing seat, pull upward on front of seat to be sure it is locked in position. If seat is loose, it could shift position during vehicle operation causing loss of control and personal injury.

5. Remove adhesive backing from pad (4) and apply pad to underside of passenger seat.
6. Remove backing paper from H-D emblem (1) and install emblem on top of knurled knob (2).
7. Slide front of passenger seat into the rider seat bracket.
8. Install knurled knob into fender retention nut to secure passenger seat. Tighten with fingers only.

⚠WARNING

After installing seat, pull upward on front of seat to be sure it is locked in position. If seat is loose, it could shift position during vehicle operation causing loss of control and personal injury.

NOTE

If passenger seat is removed, install the knurled knob in the threaded hole in the fender. This will aid appearance and prevent knob from being lost.

⚠WARNING

Do not install passenger seats on motorcycles that are not equipped with appropriate passenger footpegs and grab strap. Footpegs and grab strap will help passenger stabilize his/her position while motorcycle is in motion. If footpegs and grab strap are not installed, a passenger could fall from moving motorcycle or grab onto operator, causing loss of control and possible personal injury.



Service Parts

Part No. 51660-97

Date 1-97

Passenger Seat Kit

sp51660

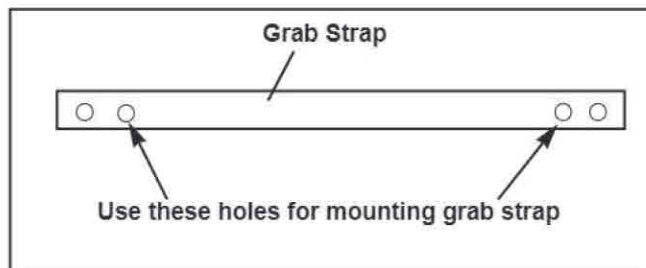
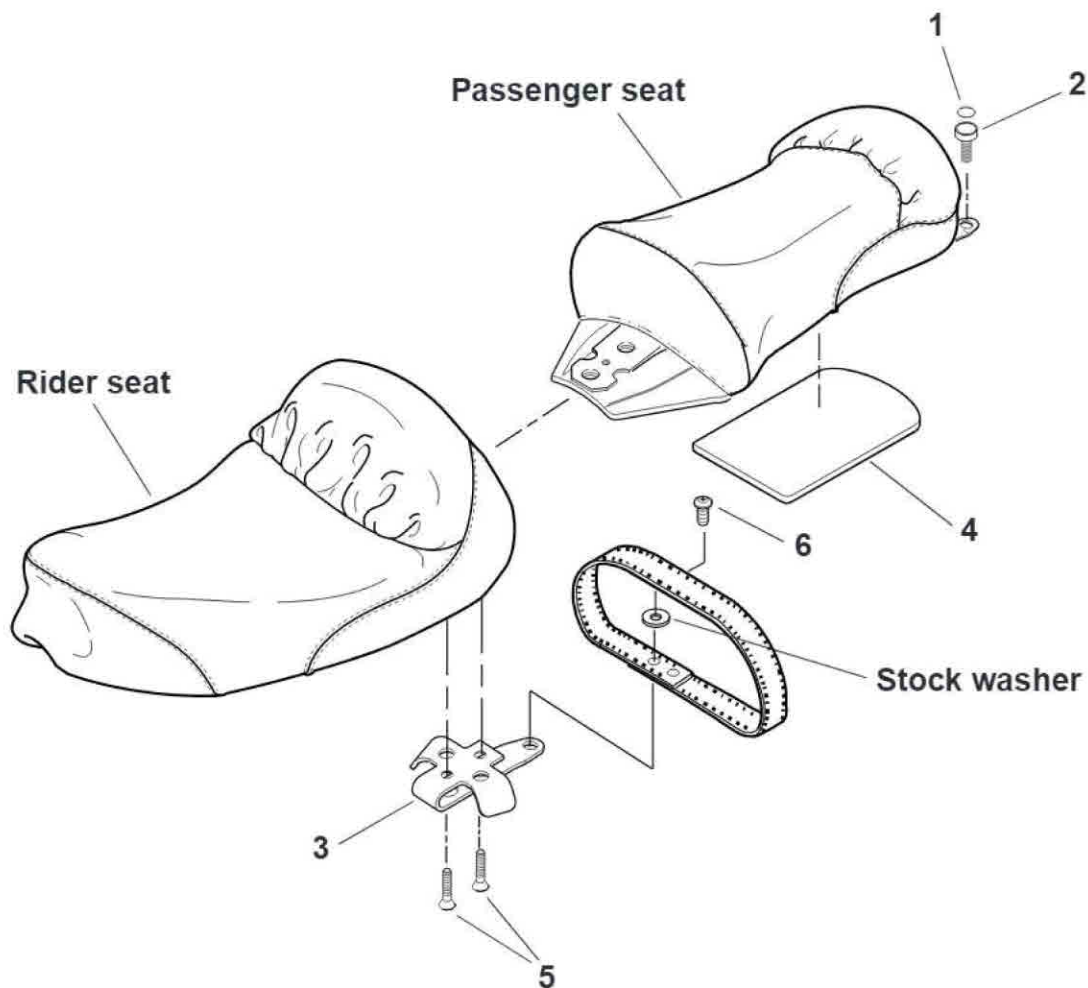

Grab Strap Holes

Item	Description	Part No.
1	H-D emblem	14628-96
2	Knob, 1/4-20 (knurled)	3694
3	Seat bracket	52706-97
4	Pad (apply to bottom of passenger seat)	52691-96
5	Screws (2) (Phillips, flat head)	2961
6	Screw (truss head)	2420