



INSTRUCTIONS

-J00957

REV. 7-25-97

Kit Number 52806-94B

SISSY BAR SIDE PLATE KIT

General

This kit is designed for installation on all 1994 and Later XL model vehicles.

See Service Parts for kit contents.

Installation

CAUTION

When removing rear fender reflectors, be careful not to damage fender paint.

1. Carefully remove reflector and any remaining adhesive from side of rear fender.

*NOTE

See Service Parts illustration. 1998 and later models and models with kit number 59722-98 installed have a support weldment under the fender and do not have a locknut or "T" spacer behind the last hole of the fender support. The screw threads directly into the weldment.

2. See Service Parts Illustration. Remove two screws (3) and locknuts that attach fender support to fender. Discard button head screws (3) and retain locknut(s)* for reinstallation.

NOTE

When installing new hex socket button head screws, make sure the steel T-spacer(s)* are still in the fender isolators before tightening the assembly.

3. Position side plate (1) on fender support as indicated. Coat threads of screws from kit with Loctite 242 (blue). Attach side plate (1) to fender support with screws (3) and original locknut(s)*. Tighten screws to 8-13 ft-lbs.
4. Obtain reflector (2) from kit. Peel off protective strip backing and firmly press reflector (2) to side plate (1), centering reflector horizontally and vertically.

WARNING

Federal Motor Vehicle Safety Standard (FMVSS) 108 requires all motorcycles to be equipped with side reflectors. The mounted saddlebags will cover the factory installed reflectors on some motorcycles. This loss of visibility to other motorists could result in an accident and possible personal injury. Install, or have Dealer install, the reflectors supplied with this kit

5. Repeat steps 1 through 4 on opposite side of fender.



Service Parts

Part No. 52806-94B

Date 7/97

Sissy Bar Side Plate Kit

i00138c

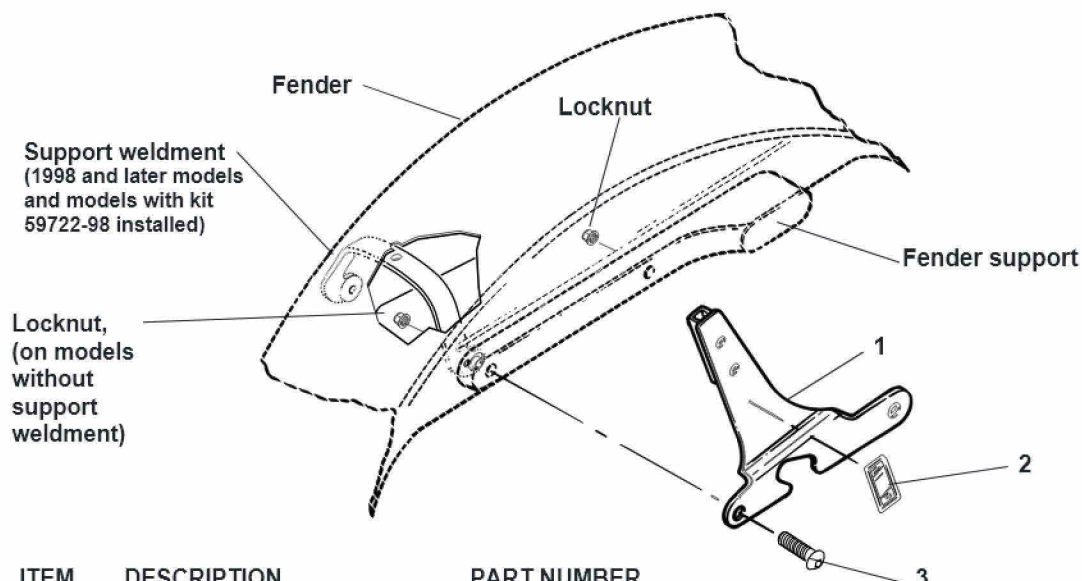

ITEM	DESCRIPTION	PART NUMBER
1	Side plate, right	52807-94A
	Side plate, left (not shown)	52808-94A
2	Reflectors (2)	59255-72
3	Screws, (4)	4187