



INSTRUCTIONS

-J01017

REV. 3-1-93

Kit Number 59628-93R

TAIL SECTION BRACKET KIT

General

This kit is designed for installation on 1982-1993 Sportster models with 883R racing seat, Part No. 52118-93R.

QTY	DESCRIPTION
-----	-------------

2	Bolt
2	Washer
2	Spacer
2	Grommet
2	Spacer, half-round
2	Locknut

NOTE

This kit is designed for closed-course competition only.

Installation

1. See Illustration. On both sides on tail section of seat, install grommets (1), making sure grommets are seated properly with all edges flush against tail section (2).
2. On one side of vehicle, install cylindrical spacer (3) into grommet (1).
3. Position half-round spacer (4) against frame member, as shown in illustration.
4. Position tail section (2) over frame. Line up grommet hole with frame hole and half-round spacer.
5. Insert bolt (5) with washer (6) from kit through grommet, cylindrical spacer and half-round washer on frame.
6. Secure assembly to frame using locknut (7) from kit.
7. Repeat Steps 2 - 6 for opposite side of vehicle.

Front of tail section attaches to tang on frame

i01462

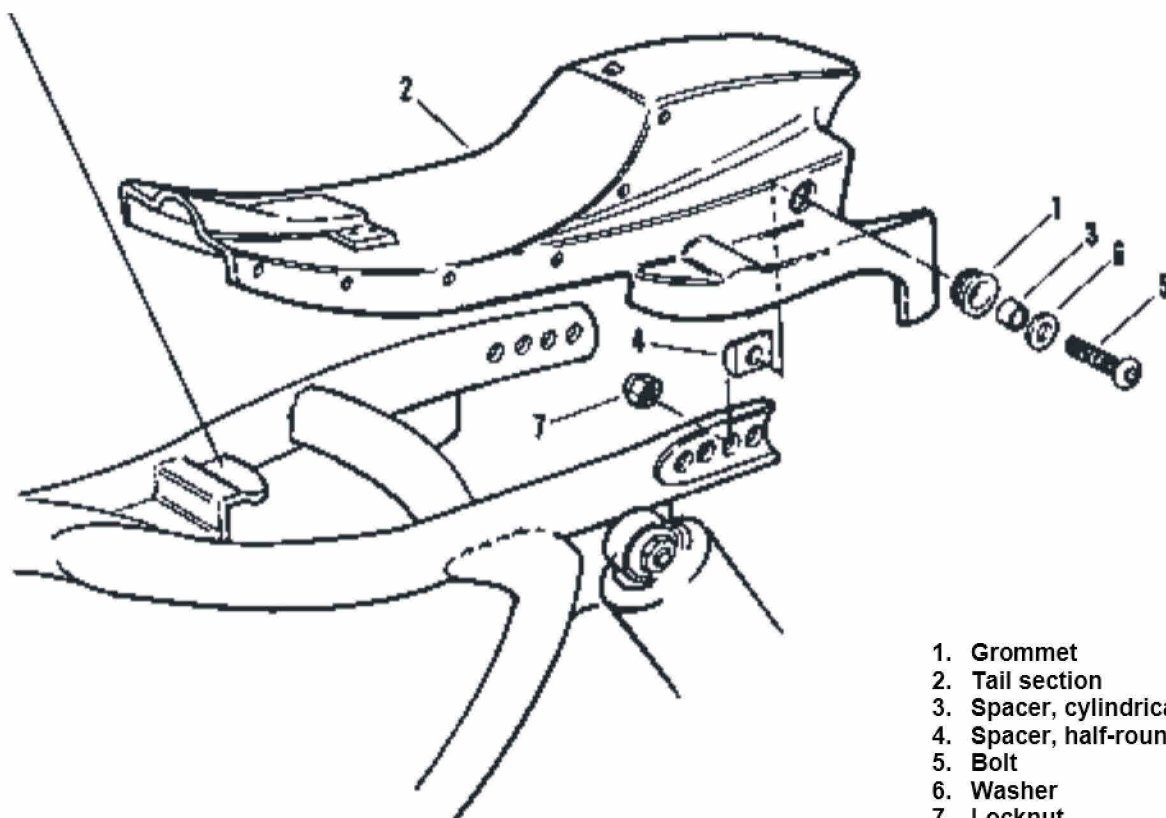

1. Grommet
2. Tail section
3. Spacer, cylindrical
4. Spacer, half-round
5. Bolt
6. Washer
7. Locknut

Tail Section Bracket Assembly