

BUELL
BYTES

COMPUTER GENERATED
TECHNICAL UPDATES & INFORMATION
FOR THE BUELL S2-THUNDERBOLT

ISSUE #1

MAY 1995

TABLE OF CONTENTS

<u>PAGE</u>	<u>TOPIC</u>
1	Service Literature
2	Service Tools
3	Technical Updates
4	Labor Code Additions Customer Service Support Personnel
5-6	Servicing Tips

BUELL S2-THUNDERBOLT SERVICE LITERATURE

A full complement of technical literature is available to support the product.

- | | |
|----------------------------------|------------|
| 1. PRE-DELIVERY & SET-UP MANUAL | 99947-95YA |
| 2. SERVICE MANUAL | 99489-95Y |
| 3. PARTS CATALOG | 99570-95YA |
| 4. WARRANTY JOB TIME/CODE MANUAL | 99997-95Y |
| 5. OWNER'S MANUAL | 99479-95Y |



Buell[®]
AMERICAN MOTORCYCLES

KENT-MOORE/ BUELL SPECIALTY SERVICE TOOLS

Replacement pads are now available for the Rear Wheel Support Stand, B-41174. These pads replace the original pads which may tear after repeated usage. The part number is B-41174-2. The price is \$2.95 per pad.

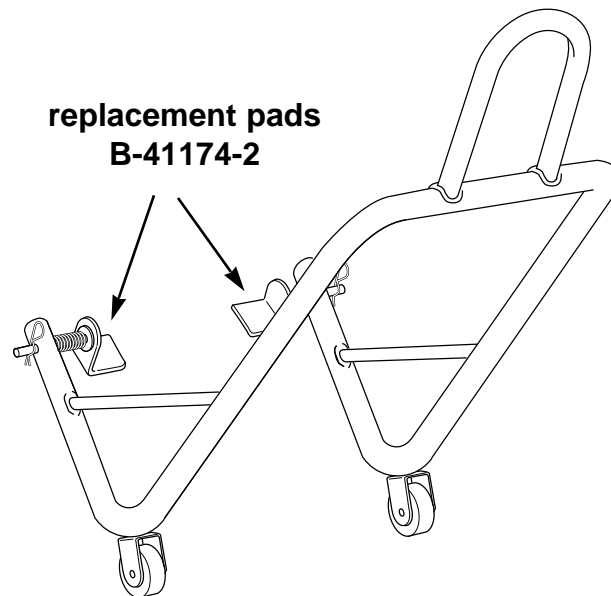

SPECIALTY SERVICE TOOL ORDERS

Kent-Moore Tool is the vendor source for Buell Specialty Service Tools. Call 1-800-345-2233 or FAX 1-800-578-7375 just as you would to place an order for Harley-Davidson tools. All Buell specialty tool part numbers begin with a "B" prefix (For example B-41174: Rear Support Stand pictured below).

Existing Harley-Davidson tools should be ordered using the numbers you're familiar with (HD-38515A: Clutch Diaphragm Spring Compressor).



**B-41174
Rear Support Stand**

TECHNICAL UPDATES

Mirror Stabilizer Kit

A mirror/instrument stabilizer kit is now available for installation on all existing Buell motorcycles. These kits are being shipped to your dealership at no charge. Details of this product update are outlined in **Service Bulletin- B-002**. If you need additional kits, they can be ordered using part number; 58892-95Y.

Pre-Delivery & Set-up Change

Beginning with vehicle # 1011, the sensor timing plate will be attached to the motorcycle and will not have to be installed during set-up. Removal will only be required if ignition timing adjustment is needed.

Parts Changes

A change has been made, starting with vehicle # 817, to the lower triple tree and the bolt which secures the top triple tree.

	<u>OLD</u>	<u>NEW</u>
triple clamp, lower	45506-94Y (solid I.D.)	45506-94YA (hollow I.D.)
bolt	45458-94Y (short)	45459-94Y (long)

New style triple trees can easily be identified by the hollow I.D. of the shaft and are a complete retrofit to all earlier vehicles. The late style, longer bolts **CANNOT** be used on early style solid triple trees.

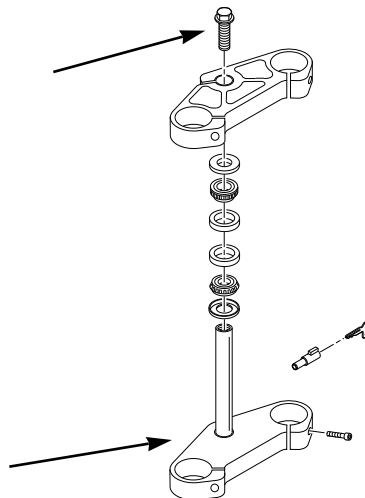

Additional Labor Codes

Two warranty/job time codes were accidentally omitted from the job time code manual. These are the times and codes for those service operations. Also listed is the labor code and time for the installation of the mirror stabilizer kit.

REPLACE FAIRING MOUNT	6265	0.7 hr.
REPLACE FIBERGLASS TAIL SECTION	2367	0.7 hr
INSTALL MIRROR STABILIZER KIT	6514	0.5 hr.

***BUELL DISTRIBUTION CORPORATION/CUSTOMER SERVICE
INTERNAL PERSONNEL***

This is a listing of people that are available to assist you from the Buell Distribution Corporation. Please feel free to contact them.

BUELL DISTRIBUTION PERSONNEL
CUSTOMER SERVICE ORGANIZATION

Chris Anderson	Customer Service	X-4392
Bill Bailey	Service Training	X-4354
Sarah Ottallah	Warranty Assistance	X-4358
Dennis Meskin	Dealer Technical Support	X-4368
Dennis Schaefer	Service Literature/ Flat Rates/ Tools	X-4379

S2-THUNDERBOLT SERVICE TIPS & UNIQUE PROCEDURES



Front brake pads must be removed before the caliper can be freed from the front wheel.



The front brake caliper and wheel must be removed in order to remove the front fender. It will not clear the fork tubes.



Removing the windshield makes it easier to remove the mirrors.



The left isolator plate must be removed in order to remove the primary cover. Remember: this affects the servicing of the clutch, drive, transmission and starter.



The fairing must be removed when performing a headlight adjustment.



Front fork servicing & fluid changes require disassembly.



When removing the air cleaner cover, be careful of the back plate. It has a special plate on the back which could be broken during removal.



Wheel bearing removal, use expanding split collet pullers with slide hammer. 3/4 in. for front & 1 1/8 in. for the rear wheel.



The front cylinder is servicable in the chassis. Don't remove the front mount unless necessary. Remove assembly through the top frame section.



The rear cylinder is also servicable in the chassis. A torque adapter will be required to access the right rear rocker bolt. A cut-down 3/16 in. Allen wrench will be needed for the rocker cover fastener.



Transmission oil changes will require muffler removal for drain plug access.