

SERVICE BULLETIN



M-1350

September 10, 2013

SHIFT SHAFT SEAL UPDATE

Purpose

The purpose of this bulletin is to inform the dealer service network of a change to the shift shaft seal on Big Twins with six-speed transmissions. The new seal (Part No. 11000101) has a garter spring to aid in sealing of the shift shaft. The previous seal (37101-84B) did not have a spring. A new seal installation tool has also been developed.

See Figure 1. The new shift shaft seal (3) can be identified by the garter spring (4) on the back side of the seal.

Vehicles Affected

This information applies to all Big Twin vehicles with six-speed transmissions.

Markets Affected

All markets are affected.

Required Dealer Action

1. Cover shaft splines before installing seal to prevent damage to seal.
2. See Figure 1. Obtain the shift shaft seal tool Part No. HD-51337 (1).

NOTES

- Using the tool installs the seal to the correct depth.
- If tool is not used, install seal to a depth of 0.125-0.135 in (3.2-3.4 mm). Do not bottom the seal in the bore. Bottom-

ing the seal will damage it and prevent it from sealing properly.

3. Make sure the garter spring (4) side of seal faces the transmission case. Drive the seal in until the tool bottoms out on the case.

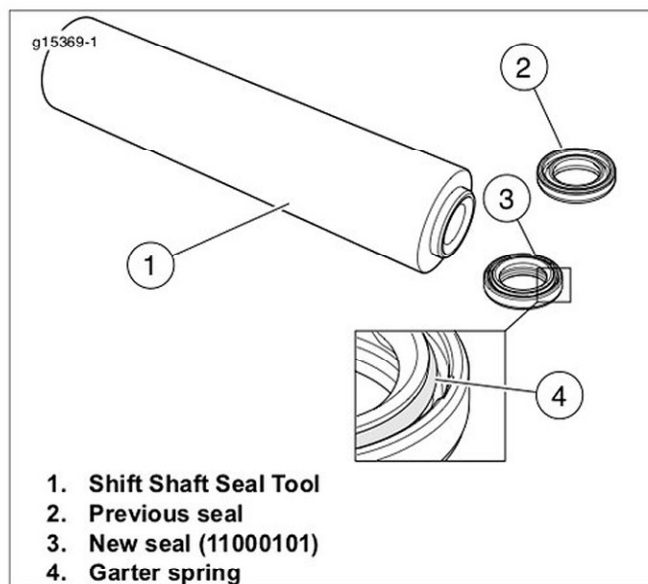

Figure 1. Shift Shaft Seal Tool (HD-51337)

NOTE

In the interest of preserving customer safety and satisfaction, always check for outstanding recalls whenever any motorcycle is brought into your dealership for either maintenance or service.

ROUTING	SERVICE MANAGER	SALES MANAGER	PARTS MANAGER	WARRANTY PROCESS MANAGER	LEAD TECHNICIAN	TECHNICIAN NO. 1	TECHNICIAN NO. 2	TECHNICIAN NO. 3	RETURN THIS TO
INITIAL HERE									

© 2013 H-D