

Camshaft Needle Bearing Removal and Installation Tool

When installing inner cam needle bearings on 1999-2005 Dyna or 1999-2006 Touring and Softail Models, tolerance stack-up and inconsistencies in crankcase casting may prevent the bearings from being installed deep enough.

After first installing bearings with installation tool **HD-42325-6**, install the camplate assembly w/ cams installed and torque fasteners, then you will rotate the cams and feel for free movement. Any binding or drag will require the bearing to be installed up to .030" deeper, with the use of the **HD-42325-14** installer.

Three flats or one half turn of the installation tool (item 12) will install the bearing approximately .030" deeper, which is a sufficient distance to prevent any clearance issues.

Kent-Moore tool kit # **HD-42325-B** includes a new tool part # **HD-42325-14**. This tool can also be purchased separately to upgrade your existing HD-42325 and HD-42325-A kits.

The **Outer Dimension** of HD-42325-6 is 1.310" The **O.D.** of HD-42325-14 is 1.100"

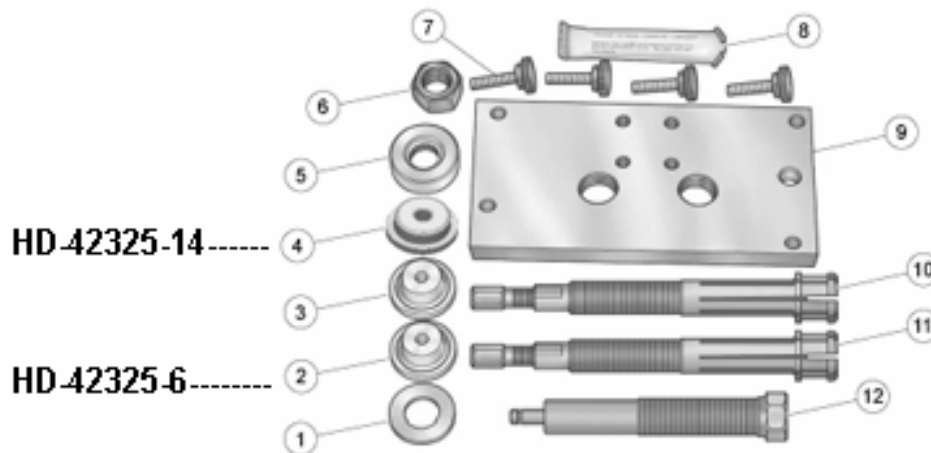

HD-42325-6

Hd-42325-14



HD-42325-6

Hd-42325-14