



TT407A: Electra-Glide Backrest Isolator Replacement

June 25, 2009



APPLIES TO	SYMPTOMS
2009 FLHTC and FLHTCU Models	• Part Availability, Installation or Fitment Updates

Electra-Glide Backrest Isolator Replacement

The passenger backrest on FLHTC/U models is attached to the tourpak lid with barrel-shaped rubber isolators. There was a material issue identified with some of these rubber isolators on mid-year 2009 models that could cause them to separate.

These rubber isolators for the passenger backrest are available separately through your parts department. (part number 52192-86A) See the index number 9 from the image below. It is not necessary to replace the backrest if an isolator fails. Warranty claims may be suspended or rejected for replacing the complete assembly when service parts are available, per page 28 of the Global Warranty Manual.

If you are working on a motorcycle with a faulty passenger backrest isolator, it is recommended that you replace all three isolators.

See the instructions that follow for tips on removing the isolators from the backrest pad.

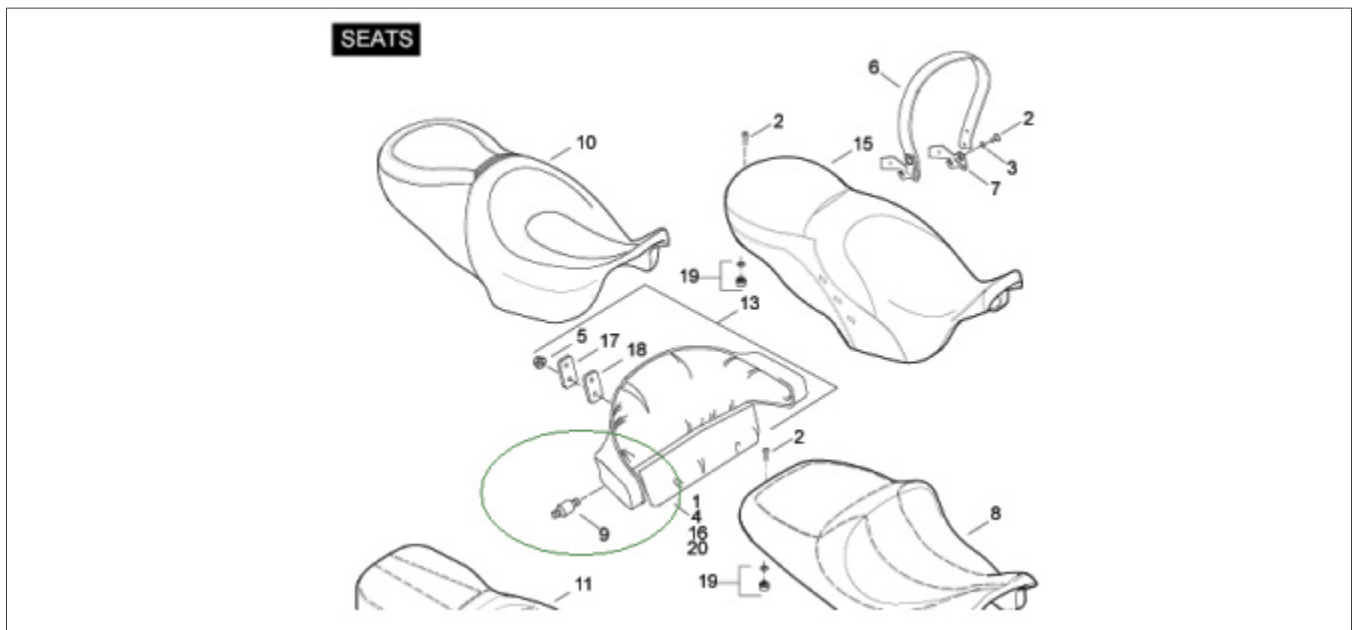

Figure 1. Passenger Backrest Isolator p/n 52192-86A

The isolators do have a thread locking compound to prevent them from coming loose. If rubber from isolator is still attached to the backrest, you may want to cut it away from the tab portion that threads into the backrest. See figure 2.

With the remaining tab exposed, rotate the tab with locking pliers to remove the threaded portion. See figure 3. If you cannot rotate the tab, you may need to notch the tab with a grinding tool to add flat surfaces for gripping.



Figure 2. Isolator Rubber Attached to Threaded Base



Figure 3. Threaded Isolator Tab Prepared for Removal